

# Kaya® TOILET ROLL HOLDER

## Features

- Circular cover plate
- Super strong 4-point wall mount
- Reversible – can be mounted left-hand or right-hand facing
- Fully concealed fixings
- Made from zinc and stainless steel
- Hex key not required for installation

**Please Note:** These products may have a visible Fienza or Watermark logo.

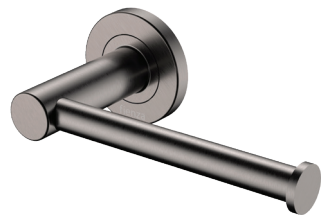
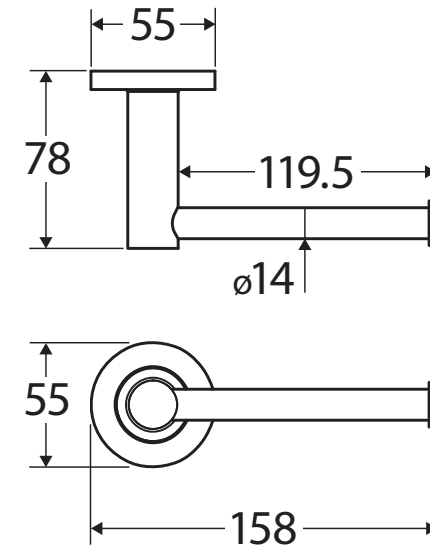
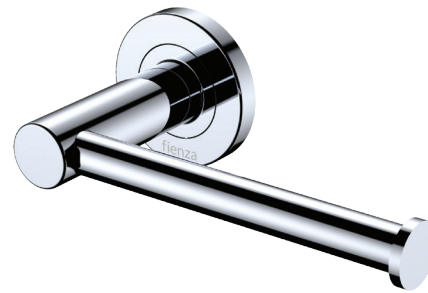

## Available in

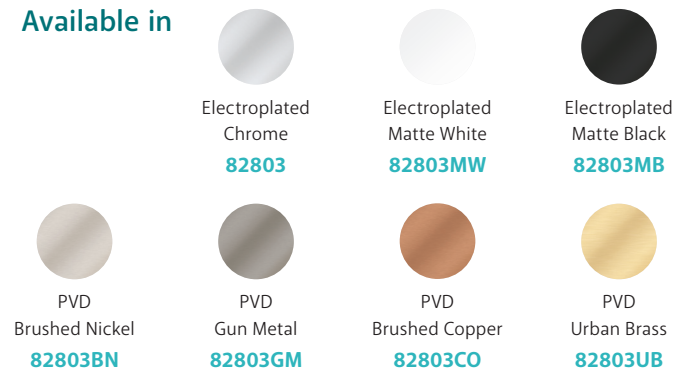

## Cleaning & Care

- Regularly clean with mild soapy water using a microfibre cloth.
- In highly polluted or coastal locations, we recommend cleaning 2-3 times per week.
- Do not use harsh detergents, bleach, cream cleaners or citrus based cleaners. These substances are abrasive and will damage the surface.
- Do not use undue pressure and wipe in one direction only

We aim to ensure that specifications are correct at the time of publication. All measurements are shown in millimetres. Always use measurements of actual product received for final specification as the technical drawing may contain differences. Due to printing limitations, physical colour may vary from the image shown. Fienza reserves the right to make modifications without prior notice.